

Type D - Standard Duty Mechanical Door Controls

REL.450 Series Standard Duty - Surface Overhead Door Holders/Stops

The REL.450 series offers the industry's widest variety of functions, base materials and finishes to fit all standard (medium) to light duty applications. The perfect combination of form and function, REL.450 series holders and stops offer effective door control and a low-profile design. The visible components are available in a wide variety of architectural finishes to complement any design.



REL.450

These versatile models can be used with almost all Relcross surface overhead door closers. Templates provide variable mounting positions allowing hold open and stop positions between 85° and 100°. REL.450 series holders and stops accommodate doors hung with conventional full mortice hinges, offset and centre hung pivot sets (consult sales office for more details).

Three distinct versions offer solutions as follows:

REL.450H Series Hold Open Model – Standard Duty

Holding the door open at a pre-determined position for long or short periods. The hold open function is an automatic mechanism that 'kicks-in' when the door is opened to a preset angle. Tension is adjusted using an Allen key.

REL.450S Series Stop Only Model – Standard Duty

Providing an effective 'out of the way' auxiliary stop when the hold open function is not a requirement.

REL.450F Series Friction Hold Open Model – Standard Duty

Used in situations where multiple hold open points are desirable. Friction tension is adjusted using an Allen key.

Each model is available in five sizes as shown in the table on page 34.

Materials and Finishes

All models are available in 300 series Stainless Steel, Brass and Steel substrates. Stock finishes include US32D satin stainless steel and SP28 powder coated silver.

Suffix .J - (Angle Jamb Bracket)

An additional option on the REL.450 series is the Angle Jamb Bracket for hinge side or flush transom mounting. The angle jamb bracket affixes to the standard jamb bracket. If ordered with the overhead stop or holder add suffix .J. If needed separately order REL.450 Angle Jamb Bracket.

Surface Installation

Surface mounted overhead door holder and stop installation does not require morticing of either the jamb or the door. The jamb bracket is mounted normally to the underside of the stop. The channel is surface mounted to the face of the door. Hollow metal frames must be reinforced in the jamb to provide strength for the jamb bracket. For timber doors and frames the available timber must be adequate for the holder specified.

Typical layout for single action doors showing push side and hinge side applications

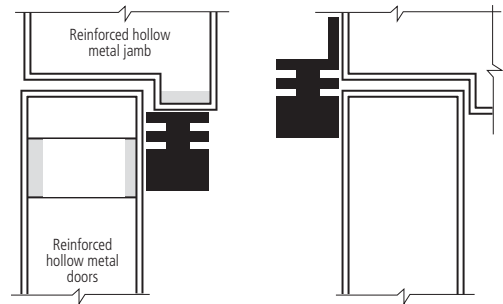

A typical surface mounted installation is shown above (left) where the jamb bracket is fastened to the stop.

Angle jamb brackets are available for hinge side mounting and for use with rebated doors or flush transom installations.

Jamb brackets with special shims for use on jambs with blade stops are also available. Advise the stop height and the appropriate shim kit will be provided.

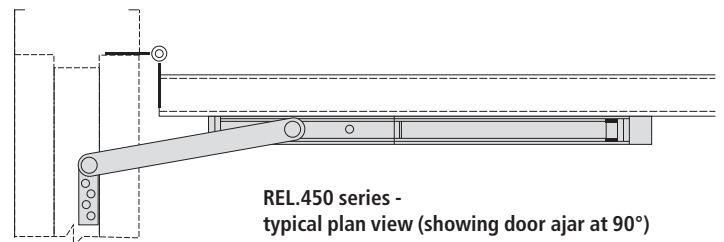

REL.450 series - typical plan view (showing door ajar at 90°)

How to Specify or Order

Example	45 — 4 — H — US32D — J
REL.450 Series	↑
Size (from table on page 34)	↑
Function (hold open, stop or friction)	↑
Finish (US32D = satin stainless steel)	↑
J (Angle Jamb Bracket)	↑