

Type C - Heavy Duty Mechanical Door Controls

REL.2000 Series - Head Frame Concealed

An Introduction

REL.2000 series concealed heavy duty door closers are designed for aluminium, hollow metal or timber doors and frames. They can be used on conventional hinge or pivot mounted doors. **Always consult Relcross when fitting closers to pivot hung doors.** Options included in this section suit head frames with either 102mm or 45mm available for concealing the closer body.

The range includes two single action head frame (or transom) concealed closers. The **REL.2030** series low profile 'Pacer' closer and the **REL.2010** closer - a concealed version of the heavy duty 'Smoother' closer (See page 25).

All **REL.2000** series concealed heavy duty door closers are handed for clockwise closing (left hand) or anti-clockwise closing (right hand) doors with mountings for the head frame and the door top rail. All models have full hydraulic, rack and pinion action with spring power adjustment and all have three hydraulic controls for **latch action, general closing speed and back-check.** Each hydraulic control is totally independent and adjusting one will not affect another.

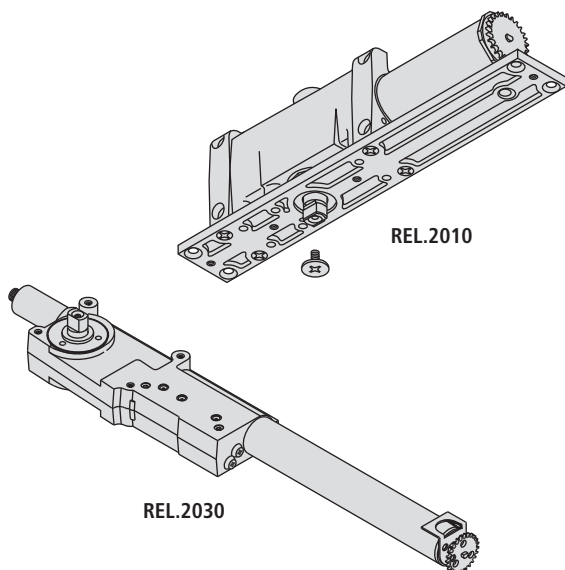

Where to Use

Wherever aesthetics are important or vandalism is expected. The **REL.2030** is ideal for use in aluminium or steel head frames (transoms) with the **REL.2010** series particularly suited to timber head frames and doors.

External Doors

Unlike traditional concealed in 'door top rail' closers, **REL.2030** and **REL.2010** series closers are designed specifically for external (perimeter) door applications and will give excellent performance under the most difficult conditions.

REL.2010 Series - Concealed (In Frame) Mounting

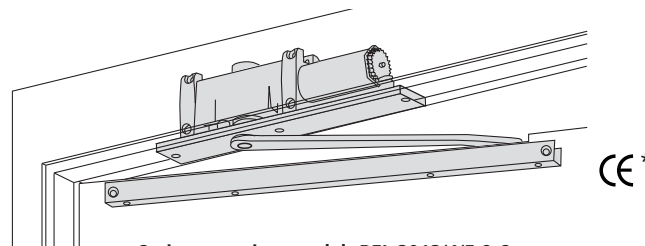

Series comprises models **REL.2013/4/5 & 6**
(consult table of sizes & options - pages 50 - 52)

- Standard **REL.2010** series closer shipped with single lever (standard) arm, mounting/finish plate, standard track, track roller and wood & machine screw pack
- Sized cylinders (See above) for interior doors to 1524mm and exterior (perimeter) doors to 1220mm
- Handed for clockwise (left hand) and anti-clockwise (right hand) closing doors
- Head frame requires minimum 102mm x 102mm 'tube'
- Standard or optional custom powder coated finish - Optional plated finish on arm, fasteners, and mounting/finish plate

Concealed Mounting

For interior or exterior doors. Single acting cylinder in head frame. Concealed arm and track in door top rail.

Maximum Opening

Butt hinge template allows 180° (trim permitting), limited to 110° when the optional bumper is installed. Hold open points are available between 85° and 110° with the optional **HO Clip** (See page 33).

Consult Relcross for all pivot mounted installations.

Butt Hinges should not exceed 127mm in width.

Auxiliary Stop is recommended - The optional track bumper assists the back-check function in cushioning the opening swing of the door. It is not intended to replace an auxiliary stop (See page 33).

Top Rail 35mm mortice required with an 8mm cut-out required at the top of the door (stop face only).

Door Thickness minimum 45mm

Hollow Metal Frames consult Relcross for installation instructions.

UK Fire Certification in accordance with EN 1634-1:2000 (timber) WFR No. 142058 **60 mins.**
BS EN 1154:1997.

***CE mark** applies to sizes 5 and 6 only.